

ROWNHAMS ROAD

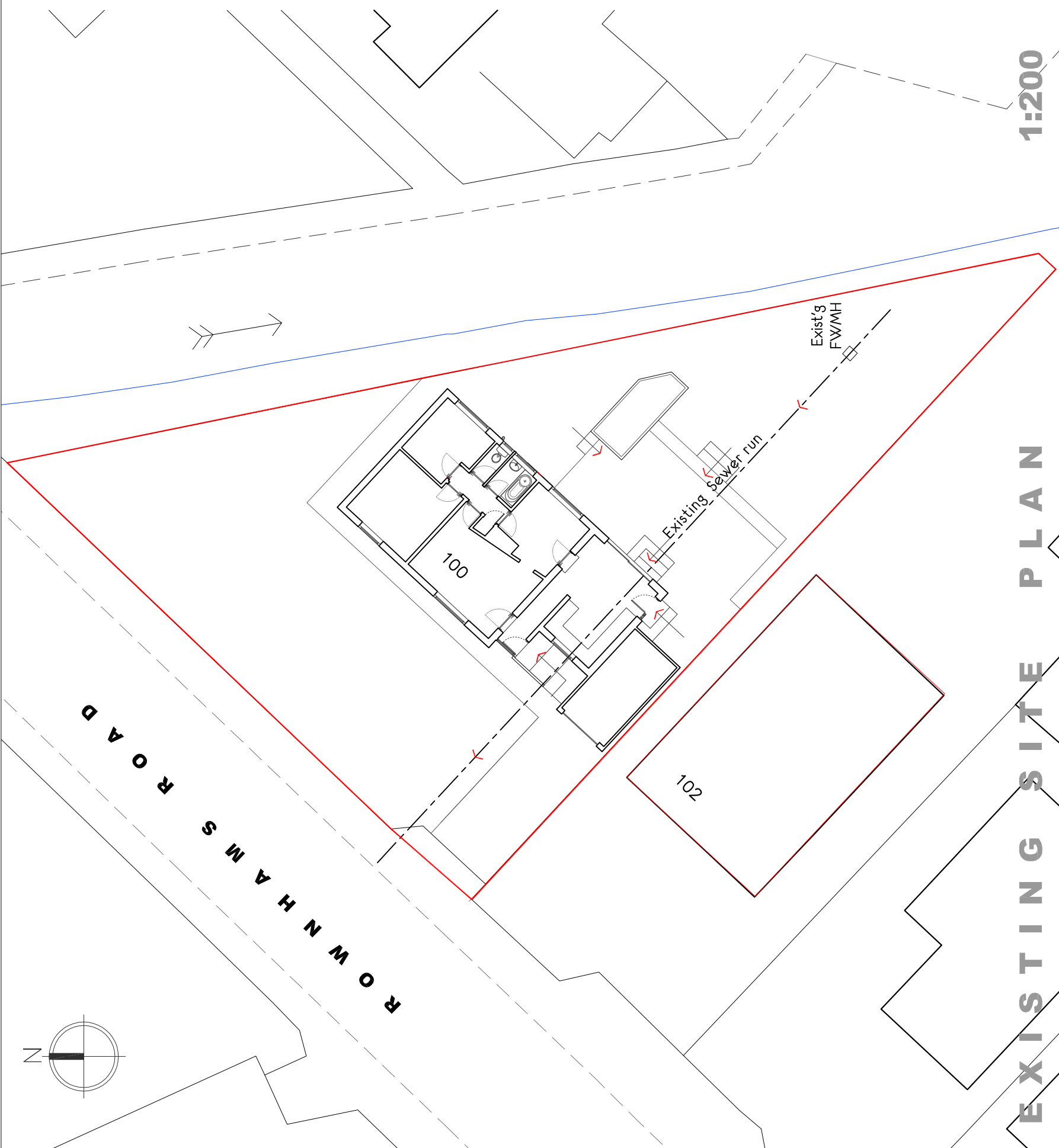

EXISTING SITE PLAN

1:200

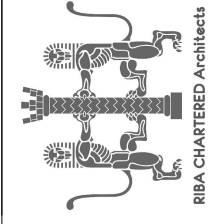
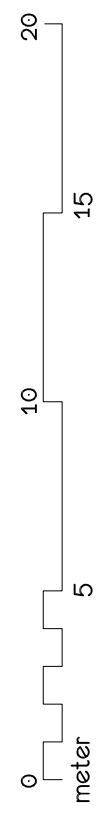

© STRINGENT COPYRIGHT:
 This drawing has been produced for:
Let Manager Ltd.
 and prepared for submission as part of any statutory Applications. It is not intended for use by any other person or for any other building project or purpose without prior permission from Toldfield Architects Ltd.

TOLDFIELD ARCHITECTS

Toldfield Architects Ltd
 5 Freemantle Business Centre
 152 Millbrook Road East
 Southampton
 SO15 1JR
 Tel: 023 80 236165

Emails:
 info@toldfieldarchitects.co.uk
 adi@toldfieldarchitects.co.uk
 kourosh@toldfieldarchitects.co.uk
 Web: www.toldfieldarchitects.co.uk

Project Name and Address:
 Proposed new roof over existing dwelling flat roofs to form a larger 4-Bedroom dwelling @ 100 Rownhams Rd, N/ Baddesley

Client:
 Let Manager Ltd.

Drawing Title:
 Existing Site plan

Project Ref:	201101	TA Code:	TA - 01	Zone:	- 01	Level:	- 01	Type:	P	Role:	- A	Number:	- P02	Rev:	
Status:	Final Design														
Project Stage:	201101 Planning														
Sheet @ A3:	1:200														
Date:	Nov 2020														

Rev:		Comments:	
Dr:		Ch:	